

ACTION PLAN FOR Anaphylaxis

For use with EpiPen® adrenaline autoinjectors

Name: _____

Date of birth: _____

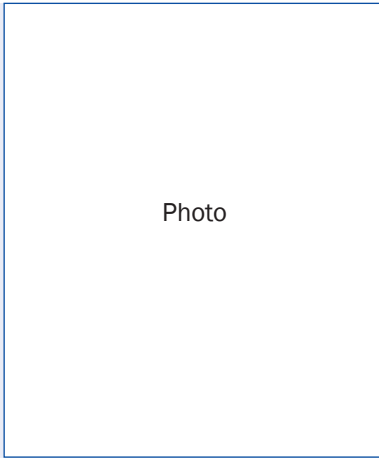

Photo

Confirmed allergens:

Family/emergency contact name(s):

Work Ph: _____

Home Ph: _____

Mobile Ph: _____

Plan prepared by:

Dr: _____

Signed: _____

Date: _____

How to give EpiPen®

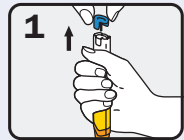

Form fist around EpiPen® and PULL OFF BLUE SAFETY RELEASE.

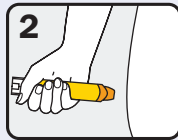

PLACE ORANGE END against outer mid-thigh (with or without clothing).

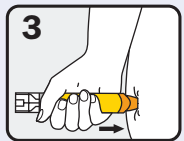

PUSH DOWN HARD until a click is heard or felt and hold in place for 10 seconds.

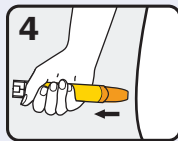

REMOVE EpiPen®. Massage injection site for 10 seconds.

Instructions are also on the device label and at www.allergy.org.au/health-professionals/anaphylaxis-resources

© ASCIA 2013. This plan was developed by ASCIA

MILD TO MODERATE ALLERGIC REACTION

- Swelling of lips, face, eyes
- Hives or welts
- Tingling mouth
- Abdominal pain, vomiting (these are signs of a severe allergic reaction to insects)

ACTION

- **For insect allergy, flick out sting if visible. Do not remove ticks.**
- Stay with person and call for help
- Locate EpiPen® or EpiPen® Jr
- Give other medications (if prescribed)
- Dose:
- Phone family/emergency contact

Mild to moderate allergic reactions may or may not precede anaphylaxis

Watch for any one of the following signs of Anaphylaxis

ANAPHYLAXIS (SEVERE ALLERGIC REACTION)

- Difficult/noisy breathing
- Swelling of tongue
- Swelling/tightness in throat
- Difficulty talking and/or hoarse voice
- Wheeze or persistent cough
- Persistent dizziness or collapse
- Pale and floppy (young children)

ACTION

- 1 Lay person flat. Do not allow them to stand or walk. If breathing is difficult allow them to sit.**
- 2 Give EpiPen® or EpiPen® Jr**
- 3 Phone ambulance*- 000 (AU), 111 (NZ), 112 (mobile)**
- 4 Phone family/emergency contact**
- 5 Further adrenaline doses may be given if no response after 5 minutes (if another adrenaline autoinjector is available)**

If in doubt, give adrenaline autoinjector

After giving adrenaline:

- Commence CPR if there are no signs of life
- Give asthma medication if unsure whether it is asthma or anaphylaxis

EpiPen® is generally prescribed for adults and children over 5 years.

EpiPen® Jr is generally prescribed for children aged 1-5 years.

*Medical observation in hospital for at least 4 hours is recommended after anaphylaxis.

Additional information _____

Note: This is a medical document that can only be completed and signed by the patient's treating medical doctor and cannot be altered without their permission.